



Talkback - Desktop and Rackmounted Systems

Talkback refers to the standard method of communication between broadcast studios. Each studio has either a desktop, a rack-mount, or mixer-mounted intercom, usually containing a row of switch buttons. Each switch button connects to another studio when pressed, and routes the presenter audio to it. There are 4 products in the Sonifex Talkback Intercom range:

- The **TB-6D** and **TB-6R** are general talkback interfaces which can be connected together to form a talkback system.
- The **TB-SD** and **TB-SR** are talkback units which only operate when connected to the Sonifex Station Master studio switcher.



TB-6D.



TB-6R.



Talkback TB-6D & TB-6R

The Talkback **TB-6D** is a desktop unit and the **TB-6R** is a rackmount unit. Both are used for general talkback between studios and use DC signalling.

- Provide talkback for up to 7 locations.
- Brightly lit push-to-talk buttons.
- Momentary or latched button operation.
- Built-in electret microphone, with input for external microphone.
- Monitoring of 2 external inputs, e.g. for off-air receiver.
- Auto-muting, or mixing, of external inputs, when talkback is active.
- Integrates with Sonifex S2 mixer and is compatible with other talkback systems.





Talkback TB-SD & TB-SR

The Talkback **TB-SD** is a desktop unit and the **TB-SR** is a rackmount unit. Both are used for general talkback between studios and use DC signalling.

- Provide talkback for up to 5 locations.
- Brightly lit push-to-talk buttons.
- Momentary or latched buttons.
- Built-in electret microphone, with input for external microphone.
- Monitoring of 2 external inputs, e.g. for off-air receiver.
- Auto-muting, or mixing, of external inputs, when talkback is active.
- Integrates with Sonifex S2 mixer & Sonifex Station Master studio switcher.



Station Master Studio Switcher

Station Master is part of the Sonifex range of professional audio products designed for building radio stations on a budget. It combines into a single package all the equipment required for audio distribution, studio switching, talkback and monitoring for up to 4 radio studios. All 4 units have the following:

- Studio Switching.
- Delay Control.
- Monitoring.
- Audio Distribution.
- Talkback – via TB-SD and TB-SR.
- Logging.
- In the event of a power failure to the Station Master, it will continue to route the current on-air studio to the stereo transmission output.



Station Master Studio Switcher

Station Master SM24-PPM & SM44-PMM

The Station Master **SM24-PMM** has PPM meters and is used for 2 studios. The **SM44-PMM** has PMM meters and is used for 4 studios.



SM24-PMM rear view.



SM44-PMM rear view.

Station Master Studio Switcher

Station Master SM24-VU & SM44-VU

The Station Master **SM24-VU** has VU meters and is used for 2 studios. The **SM44-VU** has VU meters and is used for 4 studios.



SM24-VU rear view.



SM44-VU rear view.

Station Master SM1 & SM2 Daughter Upgrade Cards

The **SM1** and the **SM2 Daughter Upgrade Cards** are used to upgrade the Station Master's capacity:

- Upgrade a Stationmaster SM24-PMM to a SM34-PMM by adding an SM1 daughter upgrade card.
- Upgrade a Stationmaster SM24-PMM to a SM44-PMM by adding an SM2 daughter upgrade card.

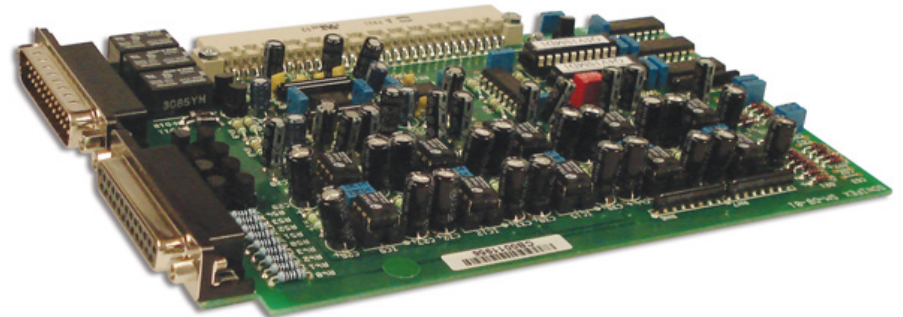



Telephone Hybrids

Telephone hybrids, or telephone balance units (TBUs) provide the interface between professional audio equipment and the public telephone network. They provide protection for your equipment and the public telephone lines, allowing for varying line signals and line conditions. Automatically cancelling out the unwanted signal they also facilitate two-way communication down a single telephone line.

- Each hybrid has a telephone line connection, a handset connection and separate terminals for audio input and output from a broadcast mixer, or other professional audio source.
- A ringing detector can be used when you need to answer a call automatically.





HY-03 Telephone Hybrid (Analogue)

The analogue **HY-03** telephone hybrid is the replacement for the HY-02, which for many years has set the standard as an excellent value, high quality telephone hybrid. The HY-03 retains many of the features of the HY-02 and adds some additional ones. Some of the features of the HY-03 include :

- Fully automatic - adapts to varying line conditions, has automatic signal limiting.
- Local and remote line hold switching – calls can be remotely switched through a mixing console.
- Momentary or permanent latching remotes can be enabled.
- Balanced mic/line input - 10k ohm balanced input selectable for 0dBu clean feed line, or microphone level with adjustable gain.





HY-03S Telephone Hybrid (Analogue)

The **HY-03S** is a **single** automatic analogue TBU, 19" (48.3cm) rack-mount unit.

Some of the features of the HY-03S include :

- Balanced mic/line input - 10k ohm balanced input selectable for 0dBu clean feed line, or microphone level with adjustable gain.
- Balanced output - 0dBu low impedance balanced output, with output gain adjustment.
- Mixed output - the output can be a mix of the caller and mic/line input signals for recording both sides of the telephone conversation.





HY-03T Telephone Hybrid (Analogue)

The **HY-03T** is a **twin** automatic analogue TBU, 19" (48.3cm) rack-mount unit.

Some of the features of the HY-03T include :

- A dual version of the HY-03S for use with two analogue telephone lines.
- Integrated ring detector - automatic call answering after a pre-determined number of rings.
- Fitted with K-break disconnect detection as standard with the ability for dial-tone disconnection using the optional HY-03DTD board.



HY-03DTD Dial Tone Detect Add-On-Board

The **HY-03DTD** is a dial tone detect add-on board for the HY-03 range of products. As standard, the HY-03 range can automatically disconnect the line once K-break is sensed. Using the HY-03DTD allows automatic disconnection in different countries based on the different ringing frequencies and cadence patterns used.

- For use with the HY-03, HY-03S and HY-03T
- Allows dial tone detection for most countries.
- Programmable by Sonifex for specific requirements, or non-specified countries.

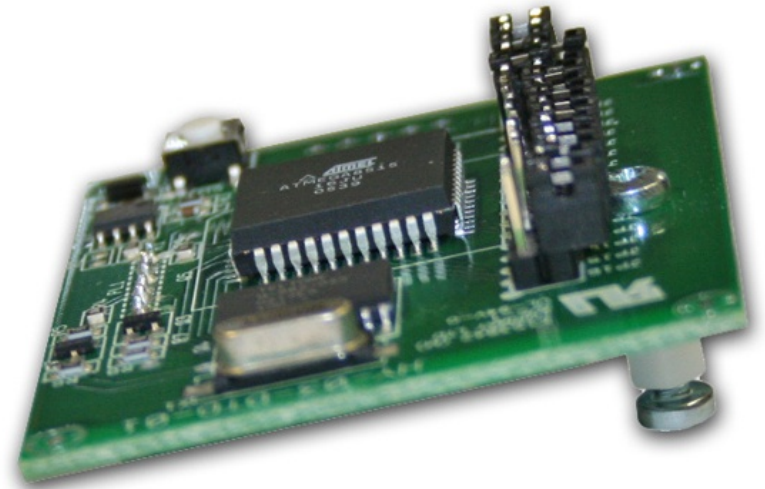



HY-03 Front Panel Conversion Kits

The **HY-03CON** is a front conversion panel kit changing the **HY-03S** 19" (48cm) rack unit to an **HY-03** free standing unit.

- Front panel only.
- Converts HY-03S to HY-03.



The **HY-03SCON** is a front conversion panel kit changing the **HY-03** free standing unit to a **HY-03S** 19" (48cm) rack unit.

- Front panel only.
- Converts HY-03 to HY-03S.





DHY-03 Telephone Hybrid (Digital)

The digital **DHY-03** telephone hybrid is probably the best performing digital hybrid in the world, with simply stunning line balance rejection figures. For the best sounding audio calls you're likely to hear, you should specify the DHY-03.

Some of the features of the DHY-03 are as follows:

- Fully automatic - adapts to varying line conditions and has automatic signal limiting.
- Fully adaptive echo cancellation to 127msec - default is 24msec.
- 76dB typical line balance rejection offering superb performance and crystal clear audio.
- Operates on analogue telephone lines, using DSP for best performance.





DHY-03S Automatic Digital TBU, Rack Mounted

The **DHY-03S** is a single automatic digital TBU, 19" (48.3cm) rack-mount unit. Some of the features of the DHY-03S are as follows:

- Front panel LED metering of receive and send signals.
- Front panel input and output gain controls.
- Built-in conferencing for 2 hybrids, so that a single telco channel on a mixing desk can receive 2 calls.
- Integrated ring detector - automatic call answering after a pre-determined number of rings.





DHY-03T Twin Automatic Digital TBU, Rack Mounted

The **DHY-03T** is a twin automatic digital TBU, 19" (48.3cm) rack-mount unit. Some of the features of the DHY-03S are as follows:

- Integrated ring detector - automatic call answering after a pre-determined number of rings.
- Automatic call disconnection. Fitted with K-break, line polarity reversal and dial tone disconnect detection, defined by the country selection.
- Automatic ducking facility allows the talent to 'shout-down', or talk over, a caller by reducing the gain of the caller's signal if it goes above a certain level.





DHY-03EC Automatic Digital TBU, Eurocard

The **DHY-03EC eurocard** single digital telephone hybrid uses the same technology as the DHY-03 but is based in a card-style format for installation in a eurocard rack frame, or in certain broadcast mixers. Supplied without a power supply, or casing, cheaper than the other units. It has most of the features of the DHY-03, with a few differences:

- The analogue input is line level only, though the 10dB professional/ consumer jumper is retained.
- There is no conferencing facility and consequently no record output option.
- The level meters are 2 tricolour LEDs.
- The level switches are now onboard 3 way jumpers.
- The remote outputs are connected via slide switches which means that the output signal can be either +5V, +15V or pull down to ground.

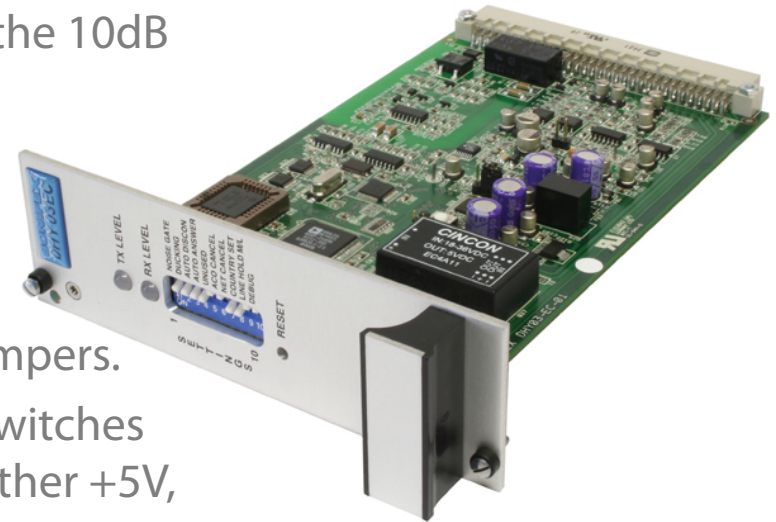



DHY-03 Front Panel Conversion Kits

The **DHY-03CON** is a front panel conversion kit, changing the **DHY-03S** to a **DHY-03**.

- Front panel only.
- Converts DHY-03S to DHY-03.



The **DHY-03SCON** is a front panel conversion kit changing the **DHY-03** free standing to a **DHY-03S** 19" (48cm) rack unit.

- Front panel only.
- Converts DHY-03 to DHY-03S.



The **DHY-03TCON** is a front panel conversion kit changing a **DHY-03** or **DHY-03S** into a **DHY-03T** 19" (48cm) rack unit.

- Front panel only.
- Converts DHY-03 or DHY-03S to DHY-03T.



SignalLED Range of RGB LED Signs For Studios

The **SignalLED** range of illuminated RGB LED signs are a new range of signs designed for outside recording, on-air & production studios, meeting rooms, conference rooms and for fixed installations. The sign itself contains the control electronics, and RGB LEDs are used, so the signs can be simply configured onsite for your particular requirements.

- RGB LEDs - any colours possible.
- Dual control inputs.
- Different display modes.
- Single or twin signs.
- Flush or end mounting.
- Single 20cm flush mounting sign.
- Double sided end mounting sign.
- Twin double sided end mounting sign.
- Custom signs.



LD-40F1ONA.



LD-40F2TX-REH.

RGB LEDs - Any Colours Possible

The illuminating LEDs in the unit are RGB meaning that the colour of the sign can be selected on installation. You can configure the sign from one of 8 colours and the images on the following pages show the default colour of each sign.

Colours:

- White.
- Green.
- Red.
- Blue.
- Yellow.
- Orange.
- Cyan.
- Magenta.



Dual Control Inputs & Different Display Modes

The sign can be controlled by either, or both, of 2 pull-low inputs, e.g. a single input can be used to control a single 'MIC LIVE' sign, or 2 inputs can be used to control a twin 'TX' and 'REH' sign with independent control of each side of the sign.

Four modes of illumination are available:

- Constant illumination.
- Flashing, regularly on/off.
- Pulsing - flashing, then off, repeated
- Off



LD-40F2ONA-SIL

Flush or End Mounting

The sign is supplied as standard so that it can be mounted flush to a wall, e.g. for the 'TX' & 'REH' sign shown. However, a mounting kit is available, LD-KE1, to mount the sign perpendicular to a wall, e.g. above a door, such as the ON AIR sign shown. A ceiling mount kit, LD-KC1 is used to mount the sign to a ceiling or the top of a cabinet.

- Flush or End Mounting.
- **LD-KE1** End Mounting Kit For 40cm Or 20cm Flush Mounting Signs.



LD-KE1

- **LD-KC1** Ceiling Mounting Kit.



LD-40F2TX-REH



LD-40E1ONA

Simple Installation

The signs are supplied with a 6V wall-wart power supply with international adapters for the UK, Europe, USA and Australasia & a 5m lead. Simply wire up your control signal(s) and DC input to the 'screw terminal block' inside the sign, route the cables through the integral cable clamp and mount the unit on the wall.

- An installation tool, the **LD-IT** can be used to hold the sign in place on the wall mount whilst you wire it up.
- The display mode and colour options are set-up using an 8 way DIPswitch, accessible during installation.

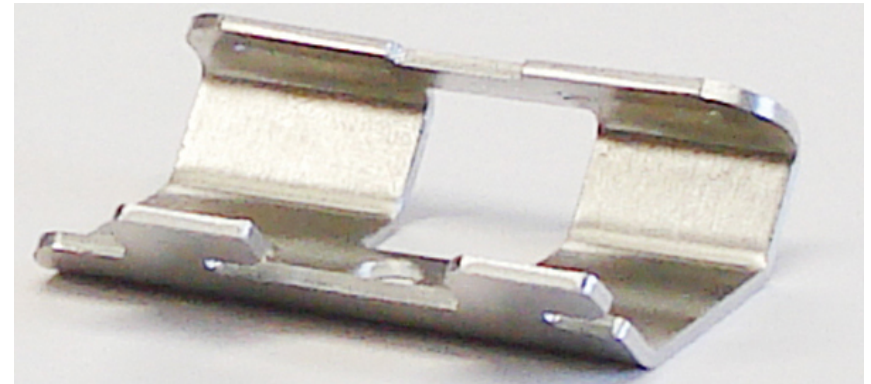

LD-IT.

Single Flush Mounting Signs (20cm)

These are the available choices for the smaller **20cm flush-mounting signs**. Custom signs can be made to order if required.

- **LD-20F1REC** Single Flush Mounting 20cm 'RECORD' Sign.
- **LD-20F1ONA** Single Flush Mounting 20cm 'ON AIR' Sign.
- **LD-20F1MCL** Single Flush Mounting 20cm 'MIC LIVE' Sign.



LD-20F1REC

Single Flush Mounting Signs (40cm)

These are the available choices for the larger **40cm flush-mounting signs**. Custom signs can be made to order if required.

- **LD-40F1REC** 40cm 'RECORD' Sign.
- **LD-40F1ONA** 40cm 'ON AIR' Sign.
- **LD-40F1MCL** 40cm 'MIC LIVE' Sign.
- **LD-40F1PHN** 40cm 'PHONE' Sign.
- **LD-40F1TRF** 40cm 'TRAFFIC FLAG ON' Sign.
- **LD-40F1ADB** 40cm 'AD BREAK' Sign.
- **LD-40F1REH** 40cm 'REHEARSAL' Sign.
- **LD-40F1DOR** 40cm 'DOOR' Sign.
- **LD-40F1OBT** 40cm 'OBIT' Sign.
- **LD-40F1NOE** 40cm 'NO ENTRY' Sign.



LD-40F1PHN

- **LD-40F1EXIT** 40cm 'EXIT' Sign.
- **LD-40F1SIL** 40cm 'SILENCE PLEASE' Sign.
- **LD-40F1MET** 40cm 'MEETING IN PROGRESS' Sign.
- **LD-40F1INT** 40cm 'INTERVIEW IN PROGRESS' Sign.

Twin Flush Mounting Signs (2x20cm)

The **twin flush-mounting sign** contains 2 x 20cm signs combined in one. These are the available choices. Custom signs can be made to order if required.

- **LD-40F2TX-REH** Twin 'TX' & 'REH' sign.
- **LD-40F2ONA-MCL** Twin 'ON AIR' & 'MIC LIVE' sign.
- **LD-40F2ONA-SIL** Twin 'ON AIR' & 'SILENCE' sign.



LD-40F2TX-REH.

Double Sided End Mounting Signs (40cm)

The **double sided end mounting sign** has the sign reading left-to-right on both sides, for example, for use in a corridor. These are the available choices. Custom signs can be made to order if required.

- **LD-40E1REC** Double Sided End Mounting 40cm 'RECORD' Sign.
- **LD-40E1ONA** Double Sided End Mounting 40cm 'ON AIR' Sign.
- **LD-40E1MCL** Double Sided End Mounting 40cm 'MIC LIVE' Sign.



LD-40E1MCL

Twin Double Sided End Mounting Signs (40cm)

The **twin sided end mounting sign** contains 2 x 20cm signs combined in one and has the signs reading left-to-right on both sides. There is one choice available. Custom signs can be made to order if required.

- **LD-40E2** Twin Double Sided End Mounting 40cm 'TX & REH' Sign.



LD-40E2

Mounting Kits

There are **3** products used for mounting the SignalLED signs: The LD-KE1, LD-KC1 and the LD-IT.

- **LD-KE1** End Mounting Kit For 40cm Or 20cm Flush Mounting Signs.
- **LD-KC1** Ceiling Mounting For 40cm Or 20cm Flush Mounting Signs.
- **LD-IT** LED Sign End Mounting Installation Tool.



LD-KE1



LD-KC1

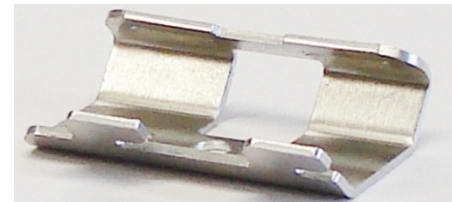

LD-IT